

April 1, 2011

Subject: **iBR Parts Substitution**

No. **2010-9**

YEAR	MODEL	MODEL NUMBER	SERIAL NUMBER
2009	GTX Limited iS	All	All
	RTX iS		
2010	GTX, GTX iS and GTX Limited iS		
	RTX, RTX iS, RTX-X and RXT-X RS		
	WAKE Pro		

When ordering the 2009 or 2010 iBR actuators, it will automatically substitute to the 2011 version, along with the needed parts to install the new execution into the vehicle it was ordered for. This is a "bolt on" direct replacement.

The original P/N from the parts catalog must be ordered in order to get new iBR execution and all needed parts.

PARTS ORDERING

iBR Actuator (P/N 278 002 321) or (P/N 278 002 476)

When ordering one of these iBR actuators, you will be shipped the following parts:

PART	PART NUMBER	QTY
New iBR actuator	278 002 606	1
U-arm	268 000 087	1
M8 x 20 hexagonal flange screw	207 382 060	2
M8 flat washer	234 081 600	2
Bushing	293 900 007	1
Fixing plate	268 000 067	1

iBR Actuator (P/N 278 002 418)

When ordering this iBR actuator, you will be shipped the following parts:

PART	PART NUMBER	QTY
New iBR actuator	278 002 605	1
U-arm	268 000 087	1
M8 x 20 hexagonal flange screw	207 382 060	2
M8 flat washer	234 081 600	2
Bushing	293 900 007	1
Fixing plate	268 000 067	1

REPLACEMENT PROCEDURE

iBR Actuator and Fixing Plate

To remove the iBR actuator and the fixing plate use the procedure described in the appropriate shop manual.

To install the new iBR actuator and the fixing plate use the procedure described in the appropriate shop manual.

To install the new U-arm and the "needed parts" use the following new informations.

U-arm

MY2009 and MY2010 Configuration

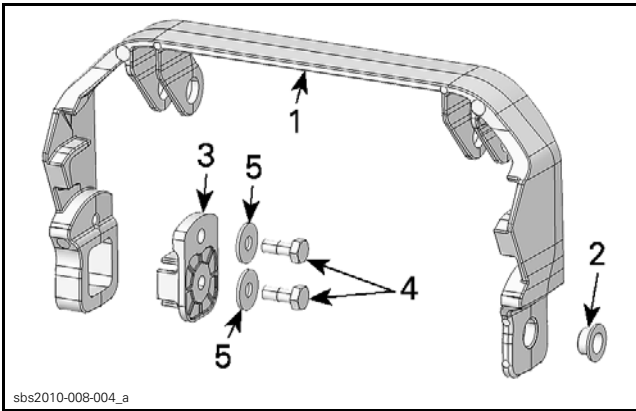

1. U-arm
2. Bushing
3. Locking sleeve (iBR key)
4. Retaining screws
5. Flat washers

New Configuration

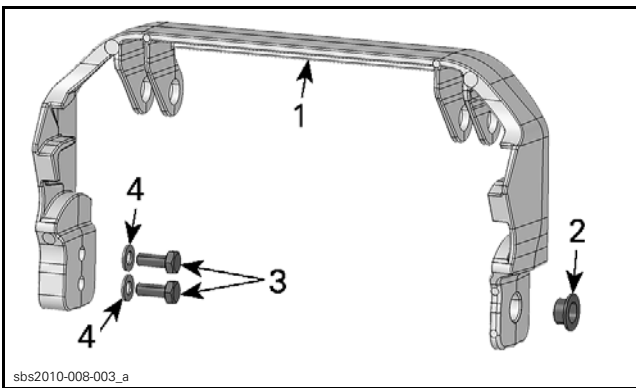

1. New U-arm
2. New bushing
3. New M8 x 20 hexagonal flange screws
4. New M8 flat washers

Install the new provided bushing on the RH external side of the U-arm.

Secure U-arm to iBR actuator using new M8 x 20 hexagonal flange screws and new M8 flat washers.

U-arm retaining screws	24 N•m (18 lbf•ft) (Apply torque twice)
------------------------	--

The installation of the new U-arm is essentially the reverse of the removal procedure. However, pay attention to the following.